

THE ROOTED LIFE

Colossians 2:7

'.....continue to live your lives in him, rooted and built up in him.....' from the Bible

Date - December 2024/January 2025

A WBC MAGAZINE

Welcome to news from the Baptist family of Wymondham, Roots Community Café and the local community.



IN THIS EDITION... More information about activities at WBC and in the community

This magazine is brought to you by Wymondham Baptist Church. If you would like to know more about us, please call, e-mail us or visit our website.

Address: Queen Street, Wymondham NR18 0AY

Telephone: 01953 606520

E-mail: office@wymondhambaptist.org

Website: www.wymondhambaptist.org

Charity No: 1199302



Welcome to this edition of our bi-monthly magazine.

We hope that you found the earlier editions interesting, this issue has more items of interest contributed by a variety of different people - we hope there will be something of interest to everyone. If you would like to write something for our next magazine, please drop it in to Wymondham Baptist Church Office by Sunday, 26th January 2025.

In this edition we hope you enjoy the following...

Contents

- Message from our Pastor page 3
- Proposed Extension page 4
- The Fruit of the Spirit page 6
- Christmas thoughts to ponder page 6
- A Word from Rosedale page 7
- Our Communal Christmas Card display page 8
- Christmas fun questions page 8
- Dates for your diary - December page 9
- Dates for your diary - January page 10
- Windmill House page 11
- Twelve tips for a greener Christmas page 11
- Christmas Wordsearch page 14
- COP29 page 15
- Some ideas to be seasonally savvy page 16
- Unscramble these Christmas words page 16
- Home from Home page 17
- WBC Church Garden and ECO Group page 17
- Hope into Action page 17
- Day of Prayer and Fasting page 18
- A Christmas picture to colour page 19

A message from Paul Smith, our Pastor at WBC.....

“So here it is merry Christmas everybody’s having fun....look to the future now it’s only just begun....”

This well known song has been played annually ever since its release in...1973!!...
It also contains the infamous words almost screamed by Noddy Holder “its Christmas”



So what’s all the fuss about ? Why is there so much excitement around Christmas ? And is it just me or does it seem that it starts earlier and earlier with every passing year! In our house I get accused lots of times of being a bah humbug because I try, mainly in vain, to not put up decorations until closer to the day, to not play the songs until we are almost there. I moan about the shops being filled with nonsense gifts from September! Promotional things being pushed through my letter box in the summer! And then the clamour and price of some advent calendars, it baffles me. I am not Scrooge at all....I love Christmas....it is the most wonderful time of the year in many ways I just feel we rush too much to get there. What we need is indeed an advent calendar, but not one that costs a fortune or is over the top in its contents. We need an

advent time counter that reminds us of what we are waiting for.....a focus on what the season is all about, Jesus.

For Christians around the world advent is a time anticipating the arrival, or "advent," of Jesus of Nazareth, the long-awaited Messiah and King. Christians from many backgrounds celebrate this time with reflections on hope, peace, love, and joy. And while their practices may look different, all focus on the hope-filled arrival of Jesus.

It’s a time to reflect on the unexpected nature of Jesus 'humble birth and join in the anticipation of when he will come again to reunite Heaven and Earth once and for all. From the first story to the last, the Bible is full of narratives, poetry, prophecy, biographies, and personal letters that inform our understanding of Advent. When the Bible talks about humans waiting for the promised anointed King who would deliver them, it can help us connect with their anticipation). When we read about people choosing joy and hope in God’s promises despite their circumstances, the meaning of Advent can take on a deeper meaning). And when the New Testament talks about a second advent, the return of Jesus, we can join in that time of waiting, shared by Christians throughout history.

So far from being a miserable old man I look forward to Christmas with great anticipation I just want time to reflect and ponder the whole wonder of it all. I want to experience the fun of Christmas that Slade sing about but also the mystery of the coming saviour, the hunger for the future, the hope, joy, love and peace that can only be found in Jesus.

I will enjoy the family gathering, the food and the games we play. I will also enjoy a chocolate every morning from my own advent calendar throughout December. However, I will not be in a hurry to get to the next bit....as I wait with excitement to cry out “ its Christmas” and I look to the future for the time when Jesus comes again and we see that its only just begun.

Whatever your plans the Christmas I pray you come to know for yourself the true meaning and in turn are able to be excited and filled with wonder at what it is all really about.

Blessings, Paul

Proposed Extension - God's provision is amazing

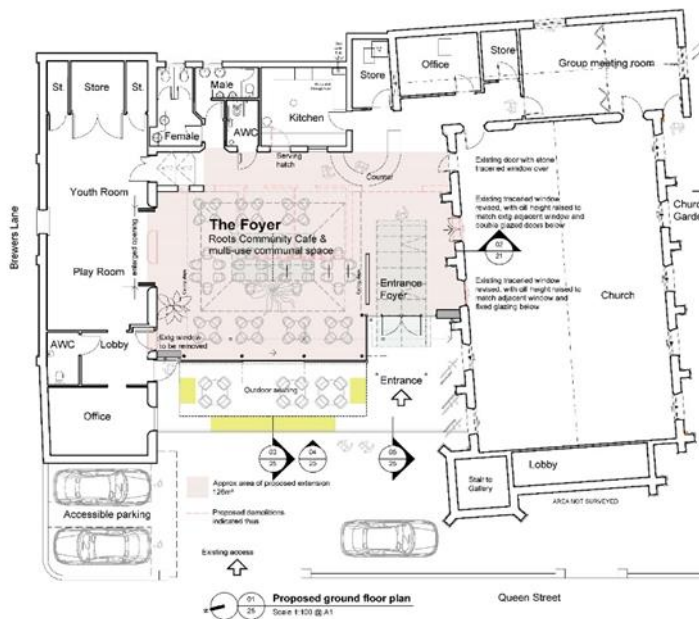

Summary

Phase 1 - Planning Permission - complete

Phase 2 - Detail Design Development - nearing completion.

Phase 3 - Construction

When the Detail Design Development work is complete we will be in a position to go out to tender. We hope to be at this stage early in 2025 and this decision will be brought to the Church Meeting before any action is taken. Before we can start work we need to have all the funds in place/promised.

The budget for the overall project (all three phases) is approximately £520,000.

Progress on Phase 2

Phase 2 is nearing completion. The last piece of the Phase 2 detail design work was brought to a conclusion during the last month with the receipt of approval of the plan to gain buildings regulations approval during construction.

The detail design for the extension incorporates an air-to-air heating (and cooling) system rather than the air-to-water heating system, coupled with underfloor heating, as originally suggested. (Both systems use heat pump technology.) The air-to-air heating approach is also expected to be the longer-term solution for our overall building heating. We already have a similar type of air-to-air heating (and cooling) unit in the upgraded kitchen.

Information has been received during Phase 2 from the energy consultant on the feasibility of installing solar panels. It is predicted that these could pay for themselves in about four years, and serve to reduce our electricity bills. Likewise incorporating further air-to air heating in the rest of the building could potentially reduce our electricity bills by half. A draft strategy paper has been accepted in principle as being the direction of travel for the future. If we do proceed it will be carried out separately from the extension project itself. It is likely that we would need to apply for planning permission for this work.

How are we paying for this?

God has been good and has challenged so many of the church fellowship to give sacrificially to this project. So far the church has raised the funds necessary to achieve planning permission, and to upgrade the kitchen following a flood due to a broken pipe, and to balance the books for 2023. We give God thanks for this and for the funds necessary to pay for the Phase 2 work, including a community grant from South Norfolk Council. This grant has covered a substantial part of the cost of Phase 2 but we still have to pay the invoices first and reclaim the grant afterwards, with a lag between the two. Our second report was submitted in mid-September and we have now received about £11,000 from this grant, for which we are very grateful. The final report is due by mid-December. We thank God for His continuing provision and leading us forward.

We continue to give thanks to God that the efforts of Grace Burke, Kate Kinsey and a small team of dedicated helpers (the “External Fund-Raising Team”) have been rewarded and that several grant applications have been successful. There are still a number of applications where so far no response has been received as the Trustees of the grant making bodies have not met yet.

Thank you for your prayers and contributions. The fund-raising efforts for Phase 3 continue alongside the Phase 2 work and beyond. Grants totalling over an incredible £340,000 have now been awarded or promised. This includes a large grant which has been provisionally granted from the Norfolk Infrastructure Investment Fund. An amazing answer to prayer! Taken together with our own funds, this means that we now only need to find another £103,000 to reach the project budget of £520,000. Please don't feel embarrassed if you are unable to contribute directly - prayer for the project is even more important. If you have other imaginative ideas for raising funds do let us know. Details of how to give are below.

The existing buildings

In looking at interfaces with the existing buildings, we are also looking at smartening up the north elevation of the church which may look scruffy compared to the new extension. Cleaning of the north wall has been completed - the brick cleaned up nicely but the stonework did not respond to treatment, much to the disappointment and surprise of the cleaners and their on-call experts. A quote has now been received for the windows. The costs of such work on the existing building are not included in the main building project, and would in any case be carried out separately. Consideration is being given to grant funding, particularly those that specialise in environmental improvements.

How can I give?

There are various ways you can give.

1) On the premises. There is an opportunity for you to give your offering as part of our Sunday worship or whenever the church is open. Envelopes marked “Building Fund” are available. A donation terminal is also available, which takes payment by credit card or debit card. Please indicate on the terminal that your donation is for the Building Fund. There is also a bucket on the table at the rear of the church where you can just put your loose change.

2) Giving through your bank - if you would like to make a donation by BACS, please ensure that it is marked 'BUILDING FUND'. Payments should be made to the credit of Wymondham Baptist Church account: **Sort code: 30-90-89 Account No. 47748863**

3) By leaving a cheque or cash at the Church Office or in the Offering Box in the church.

4) By visiting the website ...Just Giving..... and following the instructions using a credit card or debit card. **Again, please indicate that your gift is for the Building Fund**

If you pay UK tax please consider Gift Aid - a form can be obtained from the office. This enables the church to increase the value of your donation by 25% at no cost to yourself.

If you need help or more details, please contact Cathy in the office on 01953606520 or by e-mail at office@wymondhambaptist.org.

David Frith

The Fruit of the Spirit

Many years ago a friend gave me a poem written by Dr. Kenneth Moynah who served as a medical missionary in Rwanda from 1947-1964. His obituary in the British Medical Journal said this of him 'Throughout his medical career the mainspring of his life was his Christian faith'. What a great way to be remembered.

Before our homegroup studied The Fruit of the Spirit as part of the series on the Gifts of the Spirit I searched for the tiny card it was printed on so I could share it with the rest of the group. Now I want to share it with you.

Jan Hodges.

Joy is Love exulting and
Peace is Love at rest;
Patience, Love enduring
in every trial and test;
Gentleness, Love yielding
to all that is not sin;
Goodness Love in actions
that flow from Christ within.
Faith is Love's eyes opened
the living Christ to see;
Meekness, Love not fighting
but bowed at Calvary;
Temperance, Love in harness
and under Christ's control;
For Christ is Love in Person,
and Love, Christ in the soul.

Ken Moynah



A Christmas thoughts to ponder:-



He who has not Christmas in his heart will never find it under a tree.

One of the most glorious messes in the world is the mess created in the living room on Christmas Day. Don't clean it up too quickly

A Word from Rosedale



I can't believe Christmas is almost upon us again! I'm sure that the older I get, the quicker time seems to fly.

For many, Christmas can't come soon enough. For others, it can be a very stressful time of year. Difficulties within families can be magnified and those already struggling financially may feel that the burden becomes heavier.

For those who are bereaved, Christmas can be yet another painful reminder of all that has been lost. There is no right or wrong way to grieve and there is no timescale for grief. Whether our loss was recent or years ago, grief can still surge on special days. Grief expert Dr Bill Webster calls this a 'temporary upsurge of grief'. Sometimes it can be triggered by hearing a particular song that reminds us of our loved one or carrying out a family tradition. Often there seems to be no reason at all for these surges, they can hit us at the most unexpected moments and fill us with sadness.

Christmas can be a time when we experience these upsurges of grief. It is important to be kind to yourself, there is no rule book. Ignore pressure from others and do what you feel you can manage.

At Rosedale, we offer ongoing monthly friendship groups to all who have completed our eight week bereavement support group. At this time of year, they are busy organising their annual Christmas get-togethers. Though each person in this group is bereaved (some recently, others many years ago) there is still a desire to come together, share a meal and celebrate the season.

It is an important reminder that **grief and new life co-exist**. We can be grieving yet also allow ourselves to experience enjoyment without feeling guilty.

Everyone, no matter our circumstances, has a need for community, joy and celebration. There is much comfort and hope to be found in knowing that we are not alone and that the present and future can hold happy times.

Every year, Rosedale offers a complimentary **Christmas candle** to anyone who is bereaved. At eleven am on Christmas morning, we invite the collective lighting of the candles and time to pause and think about our loved ones. It can be comforting to know that we are not alone in our grief. Rosedale also extends a warm welcome to all (no matter how long ago the bereavement or which funeral director was used), to our **Christmas services of remembrance** happening throughout December in Norfolk and Suffolk. These services provide another opportunity to come together, pause and remember our loved ones at this special time of year. Details can be found on our website rosedalefuneralhome.co.uk or by calling in to your local branch.

If you would like some help with your bereavement, details of our upcoming bereavement support groups can also be found on our website. They are free and are open to everyone. These groups begin again in January and take place throughout the year at locations across Norfolk and Suffolk. Call 07901 888 122 to reserve your place.

Our Communal Christmas Card display



Many of us enjoy sending Christmas cards as a way of keeping in touch with friends and family who live away or are housebound.

However, this year we will once again have a communal Christmas card space in church for those who would like to send just one card to our whole fellowship. Last year, many of us used this idea and we had lots of shared cards on display. Not only does this help to reduce the number of cards we buy but also looks lovely and enhances the decoration in Church.

The cards last year contained some very thoughtful messages, so even if you don't use the board yourself, please take some time to look at the cards that other people have pinned up and read their Christmas messages to us all.

In addition, this year, the boards will be decorated with bunting made from last year's cards!

Nicki Waterworth

Christmas fun questions:-

1. What did the other reindeers not let Rudolph do because of his shiny red nose?
2. Where was baby Jesus born?
3. What are the two most popular names for Santa Claus?
4. In Home Alone where are the McCallisters going on vacation when they leave Kevin behind?
5. In which modern-day country was St. Nicholas born?
6. Which country started the tradition of putting up a Christmas tree?
7. According to the song, what did my true love give to me on the eighth day of Christmas?
8. What is the best-selling Christmas song ever?
9. In the Christmas Song, who does the narrator see kissing Santa Claus under the mistletoe?
10. What was the highest-grossing Christmas movie of all time?

Dates for your diary:-

December -

- 1st Worship at 10.30a.m. led by Victor Fromm
- 3rd POWER HOUR - 10.00a.m.
- 3rd Thrive@Roots - 3.15p.m.
- 4th Rosedale Monthly Meeting - 10.00a.m.
- 4th Roots Community Café - 10.00a.m. - 1.00p.m.
- 5th Home from Home - 1.30p.m. - 4.30p.m.
- 5th Menscraft - 3.00p.m. - 5.00p.m.
- 5th WYMS using premises - 6.00p.m. - 9.00p.m.
- 6th Roots Community Café - 10.00a.m. - 1.00p.m.
- 6th Friday Night Youth - 6.30p.m.
- 8th Worship at 10.30a.m. led by Rev. Bob Almond
- 8th Christmas concert with the Hemsby Singers - 2.30p.m.
- 9th Rosedale Remembrance Service - 7.30p.m.
- 10th POWER HOUR - 10.00a.m.
- 10th Thrive@Roots - 3.15p.m.
- 11th Roots Community Café - 10.00a.m. - 1.00p.m.
- 12th Home from Home - 1.30p.m. - 4.30p.m.
- 12th Menscraft - 3.00p.m. - 5.00p.m.
- 13th Roots Community Café - 10.00a.m. - 1.00p.m.
- 15th Worship at 10.30a.m. led by Neil Starling
- 17th POWER HOUR - 10.00a.m.
- 17th Thrive@Roots - 3.15p.m.
- 18th Roots Community Café - 10.00a.m. - 1.00p.m.
- 19th Home from Home - 1.30p.m. - 4.30p.m.
- 19th Menscraft - 3.00p.m. - 5.00p.m.
- 22nd Worship at 10.30a.m. led by the children & young people
- 22nd Carol Service - 6.00p.m.
- 25th Christmas Morning Worship - 10.00a.m.
- 29TH Worship Walk - Further information to follow
- 31st POWER HOUR - 10.00a.m.



Dates for your diary

January -

- 2nd Home from Home - 1.30p.m. - 4.30p.m.
- 2nd Menscraft - 3.00p.m. - 5.00p.m.
- 3rd Roots Community Café - 10.00a.m. - 1.00p.m. ????
- 5th Worship at 10.30a.m. including communion
- 7th POWER HOUR - 10.00a.m.
- 7th Thrive@Roots - 3.15p.m.
- 8th Rosedale Monthly meeting - 10.00a.m.
- 8th Roots Community Café - 10.00a.m. - 1.00p.m.
- 9th Day of Prayer and Fasting
- 9th Home from Home - 1.30p.m. - 4.30p.m.
- 9th Menscraft - 3.00p.m. - 5.00p.m.
- 10th Roots Community Café - 10.00a.m. - 4.30p.m.
- 11th Litter Pick base at WBC
- 12th Worship at 10.30a.m.
- 13th Life and Death Course - 2.30p.m. - 4.00p.m.
- 14th POWER HOUR - 10.00a.m.
- 14th Thrive@Roots - 3.15p.m.
- 14th Leadership Team Meeting - 7.30p.m.
- 15th Roots Community Café - 10.00a.m. - 1.00p.m.
- 16th Home from Home - 1.30p.m. - 4.30p.m.
- 16th Menscraft - 3.00p.m. - 5.00p.m.
- 17th Roots Community Café - 10.00a.m. - 1.00p.m.
- 17th Friday Night Youth - 6.30p.m.
- 19th Worship at 10.30a.m.
- 19th Praise and Worship - 7.00p.m
- 20th Life and Death Course - 2.30p.m. - 4.00p.m.
- 21st POWER HOUR - 10.00a.m.
- 21st Thrive@Roots - 3.15p.m.
- 22nd Roots Community Café - 10.00a.m. - 1.00p.m.
- 26th Worship at 10.30a.m.
- 26th Church Meeting - 12.30p.m.
- 27th Life and Death Course - 2.30p.m. - 4.00p.m.
- 28th POWER HOUR - 10.00a.m.
- 28th Thrive@Roots - 3.15p.m.
- 29th Roots Community Café - 10.00a.m. - 1.00p.m.
- 30th EBA Gathering at WBC 10.00a.m. - 4.00p.m.
- 30th Home from Home - 1.30p.m. - 4.30p.m.
- 31st Roots Community Café - 10.00a.m. - 1.00p.m.
- 31st Friday Night Youth - 6.30p.m.



Windmill House

Doug and I finally made it to Windmill House to lead a Harvest Thanksgiving service at the end of October. It was postponed when we had Covid, then when we arranged a new date Vic and Mary were unwell and were unable to join us to accompany the hymns with live music. So we had to resort to using recorded hymns which wasn't quite the same! As always we were made very welcome; many of the residents enjoyed singing well-loved hymns about God's creation and provision and hearing familiar scripture readings. The residents had made a little Harvest display to which I added some beautiful colourful autumn leaves from our garden.

We are looking forward to our next service on Tuesday 17th December which will be the highlight of the year's visits for us. We will be leading a Carol Service with carols and readings and a simple Christmas message. Windmill House staff and residents always go to great lengths to decorate their communal areas and make everything look festive. For those



who have a Christian background but are no longer able to get to church services this simple ministry every 2 months is much appreciated. We are hoping that in future other churches in Wymondham may be able to lead some services.

Please continue to pray for the staff and residents of Windmill House and for our team from WBC that we may be a blessing and encouragement to everyone we meet there. Thank you.

Jan Hodges.



Twelve tips for a greener Christmas



How can we be better at caring for creation and each other through healthy, eco-friendly and sustainable choices at Christmas? The ideas below could make a world of difference, and a difference to the world. Take time to pray, reflect, and consider acting on one or two, or however many you like! You may find the change is for life and not just for Christmas.



Start with your advent calendar. Support overseas farmers by ensuring that your advent calendar, and any Christmas chocolate, is [Fairtrade](#). You'll be helping those farmers to make a decent living and encouraging them to farm in a more ecologically sustainable way with every bite.



Rent a tree. Did you know that, in the UK, 6-8 million real Christmas trees go to landfill every year? With a [Christmas tree rental scheme](#) you can enjoy a real tree knowing that it will be replanted later. Alternatively, dress up a living tree in your garden - add lots of bird feeders and fat balls, and some outdoor fairy lights to make a feast for your eyes and the birds. Or, visit the [British Christmas Tree Growers Association](#) to find out about buying an organic, FSC-certified, or locally grown Christmas tree.



Go for a natural wreath and decorations. Holly sprigs, ivy trails, pinecones, rose hips... Take a bag, go for a walk, and see what you can find! Make sure that you have permission from the landowner before you start snipping. Don't take too much and do leave some berries for the birds. Source as much as you can from what's already dropped. Then get creative and make a beautiful wreath and Christmas decorations from natural materials.



Re-use cards and wrapping. Help reduce the huge number of trees that go into making Christmas tags by re-using old Christmas cards. Recycle the section that carries the greeting, cut out the picture and use that as a tag. You could use fabric remnants and ribbons to make simple, drawstring gift bags in various sizes. Use these for your family and close friends and they could be reused for years to come. Recycled brown paper has a much lower ecological footprint than Christmas wrapping paper. Young children might enjoy decorating it and that might buy you five minutes to get all those other Christmas jobs done!



Create homemade gifts. Baked goods, for example, or buy gifts from a charity shop - you'll be amazed at what can be found. You could buy an attractive glass or vase and fill it with chocolates or flowers. Kilner jars, and other glass jars, filled with small items also make attractive gifts.



Make sure your gifts don't cost the earth. Many beauty products contain palm oil. Its production causes mass deforestation, air pollution and human rights abuses. Read labels carefully. Avoid products with unsustainable palm oil. This [palm oil free list](#) can help you choose products and retail outlets that are less destructive to the natural world.



Give the gift of time. Too many unwanted gifts end up in landfill. Here's an idea. What about a gift of cooking for someone once a month for a year, taking them for a coffee, babysitting, house cleaning... or whatever. Just make a 'gift of time gift voucher' and put it in a card for them.



Dim the lights but not the joy! LED Christmas lights help to save energy and money. You could make your table festive with some candles, scented ones perhaps. Use eco-friendly candles made from beeswax, soy or other vegetable alternatives - avoid paraffin-based candles. And empty jars with some ribbon make beautiful DIY candleholders.



Remember the reason for the season. Practising generosity and hospitality is a great way to show Christ's love at Christmas. Invite someone who'd otherwise be on their own, to join you on Christmas Day. It's also a way of reducing energy consumption as they'll share your heating and cooking!



Try a meat-free Christmas meal. A high-meat diet causes environmental problems, be it overgrazing of land, pollution, or the intensive use of water or fossil fuels. Have a conversation about this with the people you'll be eating with. Would they consider a meat-free Christmas? Would they be willing to try a tasty new vegetarian recipe? If you do eat meat, make sure it's free-range or organic, and buy it from a local farmer or independent retailer.



Recycle right. More waste ends up in landfill over Christmas than during the rest of the year, so it's a great time to review your recycling set up. Different local authorities offer different recycling provisions, so find out exactly what you can recycle at home by entering your postcode [here](#). For information on how to recycle anything you're not sure about see [here](#). *Don't forget - most wrapping paper is not recyclable. You can test it by doing the 'scrunch' test. If it springs back, it isn't recyclable. And always remove the sellotape before recycling.*



Carry on caring for God's earth throughout the year. Nature needs us more than ever. By giving regularly to A Rocha UK, you'll be helping nature flourish here in the UK. You can make a one-off donation or give regularly [here](#).

Choose a change to make this Christmas. Be gentle on yourself and be realistic but challenge yourself too.

This article has been taken from the A Rocha website (<https://arocha.org.uk/our-twelve-tips-for-a-greener-christmas/>)

Eco team



WORD SEARCH

CHRISTMAS



X R M L Z F P G C E I O D O A E U M
K T P E G G N O G O D U T Q L B E G
K V S E S U C K C C O Q Z A I L M I
H N C T R M W H J D H K N N G X Y X
O N M C A E T N W J H N I G H U O U
W J T E A R A Z B E W P O E T T C W
F Q E J U R H O B Z B E H L S P U D
Y R A G L Y O P B P F H A Q A M A V
T Q Q V K G L L T M B Y L L H E W S
H Q C C H X L M S R H W N E R H D A
R K A H R G Y E L V E S S B G K J N
W F N R L V O I Z Y R T R I I D X T
Z C D I N B W W E T N E E S D K S A
I C Y S T T S W U E G L I T J Z L C
O C C T U P U O S N S F N O B C V A
C R A M N I G E I E U R D C V M J B
V Y N A J I R G N L I S E K O B Z X
P E E S N P R H B Q U Y E I M M O P
O I S O R N A M E N T U R N D S Y W
V B M W X M Y C W S H P Q G V Y V J



- | | | | |
|------------|-------------|----------|----------|
| ANGEL | COOKIES | LIGHTS | SANTA |
| BOW | EGG NOG | MERRY | SLEIGH |
| CANDY CANE | ELVES | ORNAMENT | STAR |
| CAROLS | GINGERBREAD | PRESENTS | STOCKING |
| CHRISTMAS | HOLLY | REINDEER | TREE |



COP29 11-21 November 2024

Dave Gregory is the convenor of the Baptist Union Environment Network ([BUEN](#)), and recently offered a reflection and prayer points on the Baptist Together website for COP29, which ran from 11-21 November in Baku, Azerbaijan. The full article can be read here:

https://www.baptist.org.uk/Articles/700908/Prayers_and_a.aspx

His article makes for challenging reading although he does point to glimmers of hope and he concludes his article with these questions for our consideration:

‘What can we do in our everyday lives of discipleship to fulfil the primary call of God to mission - “The Lord God took the man and put him in the Garden of Eden to work it and take care of it.” (Gen 2:15)?’

and

‘Will we embrace the primary missional call of God to share in his care for creation and as Jesus’ disciples “Go into all the world and preach the gospel to all creation.” (Mark 16:15)?’

Dave Gregory continues with the following:

‘Prayer is good place for action to begin and over the next few weeks, the nations of a burning world need them. So, please join with BUEN and many others in praying for COP29.

- ***Pray for Commitments** to be made by richer nations to support poor nations cope with the impacts of climate change that they feel now and increasingly so in the future.*
- ***Pray for Oneness** among the groups gathering in Baku; that the Spirit of God will be at work drawing people towards consensus of view and action that will meaningfully address the causes and consequences of climate change now and in the future,*
- ***Pray that Progress** will be made towards deeper cuts in carbon emissions, particularly from nations who have contributed most to the rises of warming gases in the past, and those who contribute most today.’*

By the time we read this article, COP29 will have finished but we can still pray for all those world leaders who have the opportunity and responsibility to make good the promises and pledges made at the summit

As individuals, Dave says:

'The challenge of what living as disciples of Jesus in an age of climate change remains for each of us.'

As a fellowship and as individuals at WBC, how can we meet that challenge every day in our church and own lives?

Nicki

Some ideas to be seasonally savvy

December:-

Make use of Christmas leftovers. Invest in a kitchen composter to take household food scraps. Add to your outdoor compost or directly onto the soil.

Protect your potted plants from cold winter weather by grouping them together in a sheltered spot in your garden.

January -

Make the most of the rain this month by using buckets to capture over and above what your waterbutt collects.

Stock up on feeders and give birds a tasty treat by soaking dried fruit. Keep bugs snug by building homes from natural materials like bamboo.

Unscramble these Christmas words:-

1. AHRTEW
2. TNIGERGSE
3. RMYER
4. OTFYRS
5. TAYRP
6. TTOSNEAIIP
7. ERETALCBE
8. SOANSE
9. MAIYFI
10. LJLOY

HOME FROM HOME

Our Warm Space - Home from Home has re-opened - each Thursday afternoon 1.30p.m. - 4.30p.m. We have welcomed some new faces as well as old friends. In all we have been about 14/15 in number and time has been spent chatting and enjoying one another's company as well as playing games, doing jigsaws and enjoying the tea, coffee, cake and warm snacks. As the days get colder it has been good to spend time in the warm together. We are planning a Christmas celebration on December 19th. If you would like to join us for this or any other session for the whole time 1.30p.m. - 4.30p.m. or part of the session you would be most welcome.



Cathy

WYMONDHAM BAPTIST CHURCH GARDEN AND ECO GROUP



The ECO group and garden team are planning a plant sale and seed swap on Saturday, 12th April. If you have any plants that you can take cuttings from and nurture over the coming months, please do this and bring them along for our plant sale and seed swap.

If you look in the church garden you will see that Keith has been doing a lot of work clearing a corner

for our new seating area. This will be paved ready to take two chairs and provide a quiet area in the garden.

In the Spring and Summer next year we will be looking for help with weeding and watering - is this something you could help us with? Anyone interested please speak either to Shirley or Cathy.

Hope in Action

What is Hope in Action? - Hope in Action began early in the 2000s when the founder had a conversation with a rough sleeping ex-offender. This led him to ask what more could churches do? He decided to invest his own money into Hope into Action's first home in Peterborough in 2010.

Now over 350 investors are sharing over £26,000,000 of wealth with the homeless in over 106 Hope into Action run homes.



If this is a work that you would be interested in supporting by offering friendship and support to the family who move into the Hope Into Action home in Wymondham please speak to a member of the Leadership Team. There is a book about the work that is available to read - please see Cathy to borrow the book.

Thursday 9th January 2025

Day of Prayer & Fasting for 2025

***“Commit to the Lord whatever you do,
and He will establish your plans.”***

Proverbs 16:3 WBC's Verse of the Year 2025

So we'll start the year as we mean to go on!.... committing the year, ourselves and all our plans to the Lord in prayer.

- **6pm-8pm all-church Prayer Gathering at WBC**
- **Prayer Room** open all day for personal/group prayer
- The *Tuesday Prayer Group* will provide **ideas and inspiration** for personal prayer, fasting and as we join together to pray as one at the end of this special day



A Christmas picture to colour



***WHAT CAN YOU
CONTRIBUTE TO
THIS PAGE IN THE
NEXT ISSUE???***